

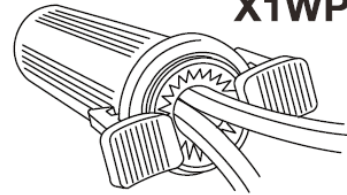

**X1WPC**

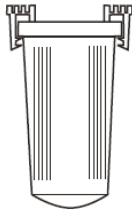

## Snap-Locking Waterproof Connectors Pre-Filled with Silicone



18 to 10 AWG stranded - Black

**Minimum 2 #18 AWG - Maximum 3 #10 AWG with 1 #18 AWG**

1.480 in, 37.64mm wide (handles)  
 1.157 in, 29.63mm wide (cylinder top)  
 2.270 in, 57.68mm (at tallest including handles)

- Sealant temperature: -40° F to 400° F
- Copper and/or aluminum wires, solid or stranded
- For low-voltage connections only - Maximum 30 Volts

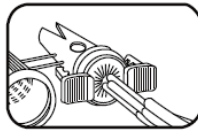

1. Insert

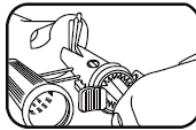

2. Bend

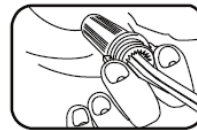

3. Close



When using both solid and stranded wire, wrap stranded wire around untwisted solid wire.



Special features - Bending sleeve for solid wires and round hole below "V" to accommodate large wire combinations.

## Conectores impermeables con cierre rápido prellenados con silicona

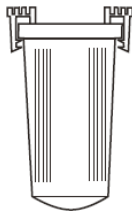

18 a 10 AWG torones - Negro

**Mínimo 2 #18 AWG - Máximo 3 #10 AWG con 1 #18 AWG**

1,480 in, 37,64mm de ancho (mangos)  
 1,157 in, 29,63mm de ancho (extremo de cilindro)  
 2,270 in, 57,68mm (en el punto más alto, incluyendo los mangos)

Temperatura del sellante: -40° F a 400° F  
 (-40° C a 204° C)

Cables de cobre o aluminio, sólidos o de torones  
 Solo para conexiones de bajo voltaje: máximo 30 voltios

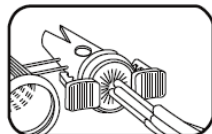

1. Insertar

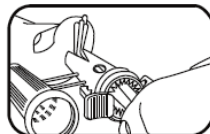

2. Doblar

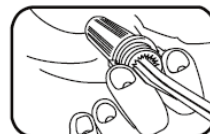

3. Cerrar



Cuando use cables sólidos y de torones, enrolle el cable de torones alrededor del cable sólido sin enrollar.



Características especiales: manguito curvado para cables sólidos y orificio redondo bajo la "V" para combinaciones de cables de gran tamaño.